

SCIENCE LABS RCP

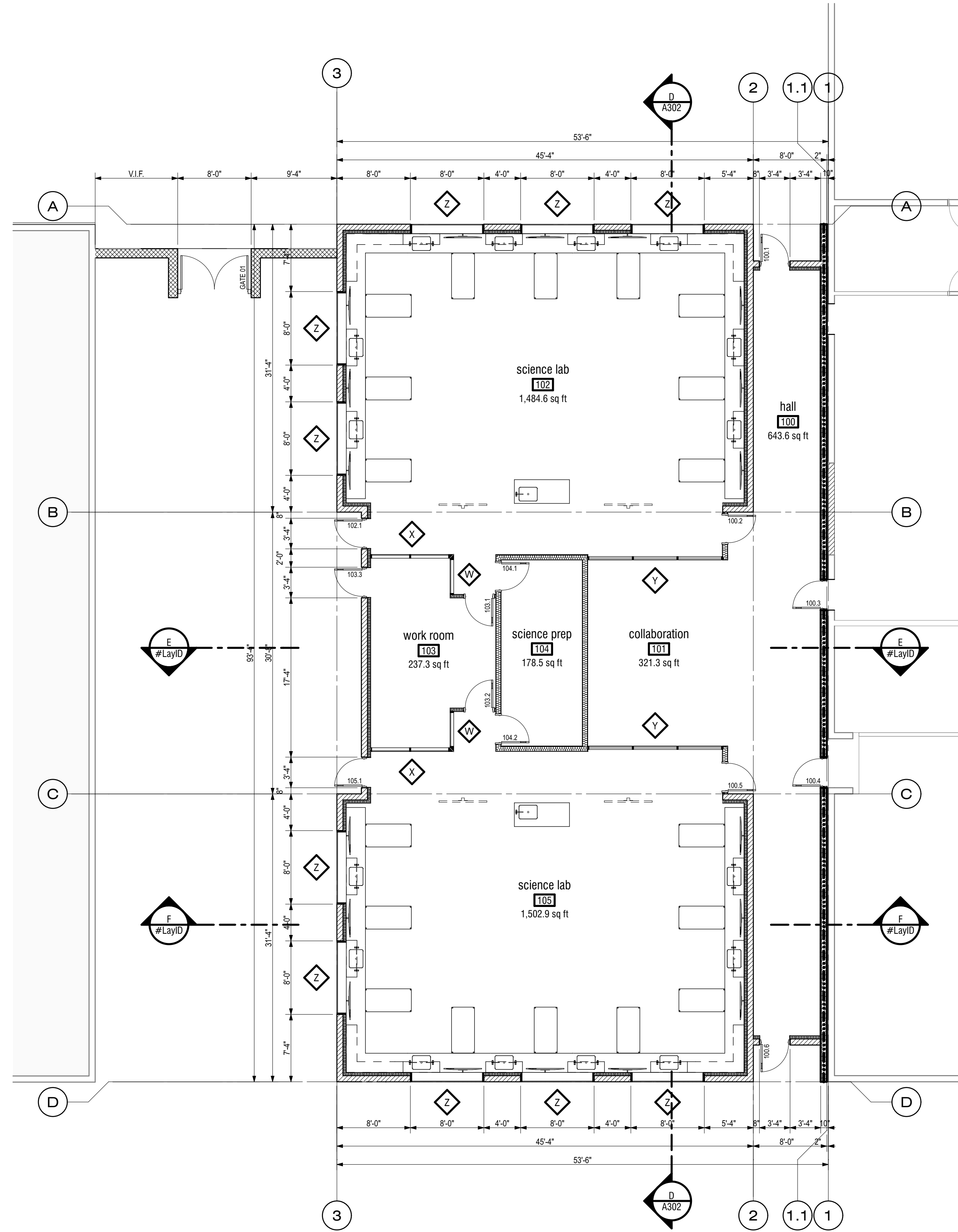

SCIENCE LABS FLOOR PLAN

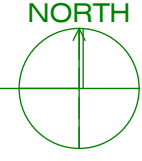
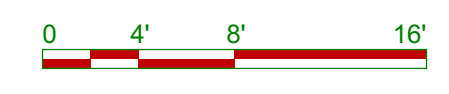
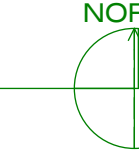

FLOOR PLAN GENERAL NOTES:

- A. Keynotes and legends are typical for all floor plan sheets, and may not apply to each sheet.
- B. Dimensions are to face of masonry and studs and centerline of columns unless noted otherwise.
- C. See enlarged floor plans and details for specific locations of plumbing fixtures.
- D. Field verify all dimensions prior to fabrication of any cabinetry, frames, structural items, etc.
- E. Provide painted access panels in walls and ceilings at concealed items, such as valves, shock absorbers, controls, switches, etc., and any other items that may require access. It is the Contractor's responsibility to determine access panel locations.
- F. All guardrails and handrails shall be fabricated and installed in accordance with all applicable codes, regulations, and AHJ.
- G. Seal all penetrations in fire rated assemblies as required by all applicable codes. Permanently label all penetrations and assemblies.
- H. Verify and coordinate all requirements for owner furnished items, prior to performance of any work that is to accommodate and interface with such items.
- I. All angles are increments of 45 degrees unless noted otherwise.
- J. Extend wall insulation from floor line to meet roof insulation.
- K. Provide "Fry" reveal FDM 625-75 or equal at all gypsum board to masonry or concrete transitions.

FLOOR PLAN KEYNOTES:

1. Keynotes will automatically wrap to the next line and tab accordingly.
2. There is no need to return at the end of a line and manually tab text to align.
3. Provide a blank line in between each note paragraph
- 4.
- 5.

REFL. CEILING PLAN GEN. NOTES:

- A. Ceilings and other suspended items shall be attached to structure by fully embedded or "shear" connection; pull out connections are not acceptable.
- B. All gypsum board ceilings shall be 5/8" type "X" gypsum board on light gauge framing or suspension system.
- C. Ceiling and soffit heights noted on Reflected Ceiling Plans, are above finish floor.
- D. Center all devices, sprinkler heads, etc. in ceiling tiles.
- E. All soffits over casework to extend 1" beyond the face of casework.
- F. Provide continuous sound batt insulation above all toilet room ceilings.
- G. Fire sprinkler contractor shall reference all drawings and specifications for determining proper coverage and sprinkler head layout/design.
- H. Reveal molding to be used at all intersections of different materials. All soffit reveals shall be a continuation of vertical wall reveals.
- I. Refer to electrical drawings for location of reused, relocated, existing or new light locations. Patch all GWB ceilings with new gypsum wall board where damaged or removed for new work. Match existing depth, finish and color of ceiling to be patched.
- J. Ceiling heights indicated in existing areas are approximate. Maximize where possible. Where ceiling grids are to extend, match existing height, direction, manufacturer, style, color, and type of grid.

REFL. CEILING PLAN KEYNOTES:

1. Keynotes will automatically wrap to the next line and tab accordingly.
2. There is no need to return at the end of a line and manually tab

REFLECTED CEILING PLAN LEGEND

	GYPSON BOARD PAINTED
	PERFORATED METAL LINEAR CEILING SYSTEM WITH ACOUSTICAL LINER
	CEILING HEIGHT INDICATOR
	EXHAUST GRILL
	2x4 ACOUSTICAL CEILING
	SUPPLY AIR DIFFUSER
	2x2 ACOUSTICAL CEILING
	RETURN AIR GRILL
	2' x 4' RECESSED LIGHT FIXTURE
	2' x 2' RECESSED LIGHT FIXTURE
	1' x 4' RECESSED LIGHT FIXTURE
	6' x 4' RECESSED LIGHT FIXTURE

orcutt | winslow

3003 n central ave
sixteenth floor
phoenix az 85012
mail@owp.com

602.257.1764 t
602.257.9029 f
www.owp.com

© 2015 the final stage of electrical drawing is an instrument of service and the property of the Orcutt/Winslow Partnership and shall remain their property. The design professional shall not be responsible for any alterations, modifications or additions made to the drawing by any party other than the design professional. Use of this drawing shall be limited to the original use for which it was prepared and publication thereof is expressly limited to such use, without reproduction. Unless otherwise agreed in writing, design professional assumes all copyright or other proprietary interest in this drawing, and it may not be re-used by any other person without the design professional's written consent. Publication in any method in whole or part is prohibited without the written approval of the design professional. Any information obtained or conclusions derived from this drawing shall be of the user's sole risk.

SCOTTSDALE UNIFIED SCHOOL DISTRICT NO. 48

**SUSD Cheyenne
Traditional School
Improvements - Phase II**
13636 N 100th St, Scottsdale, Arizona 85260

CLIENT CONTACT
Dennis J. J Roehler 480.484.8503 t
9288 E. San Salvador Dr. 480.415.8564 m
Scottsdale, Arizona droehler@susd.org 85258

PROJECT NO. 2017_037
DATE OF ISSUE 05.23.2017

REVISION NO.
DATE

PROJECT TEAM ed
DRAWN BY to sb fg al

PROJECT PHASE
design development

SHEET CONTENTS
science labs floor plan and rcp

SHEET NO.
A-103